

ACCURACY—PRESSURE MEASUREMENT

0 to 110% of Range: **±(0.05% of Reading + Floor Term)**
 Floor Term: **0.005% of FS or display resolution, whichever is greater**
 Vacuum: **±(0.25% of Reading + Vacuum Floor Term)**
 Vacuum Floor Term: **0.03 kPa for 100 and 200 kPa**
0.1 kPa for 2000 kPa

Includes all effects of linearity, hysteresis, repeatability, temperature, and stability for one year.
 All models indicate vacuum, but vacuum specification applies to 100 kPa, 200 kPa, and 2000 kPa models only.
 Not recommended for continuous use below -100 kPa.
 Refer to [XP2i-DP data sheet](#) for gauges that are intended for continuous high vacuum use.

ACCURACY—MILLIAMPERES

Accuracy: **±(0.025% of Reading + 0.001 mA)**
 Range: **0 to 55 mA**
 Resolution: **0.001 mA**
 Connection: **4 mm jacks, 19 mm (0.75") spacing**

Includes all effects of linearity, hysteresis, repeatability, temperature, and stability for one year.
 mA can be displayed as a percentage, where 0 to 100% corresponds to either 4 to 20 mA or 10 to 50 mA.
 Jacks are compatible with safety sheathed banana plugs.

OPERATING TEMPERATURE

Temperature Range: **0 to 50° C (32 to 122° F)**

Non-condensing. No change in accuracy over operating temperature range. Gauge must be zeroed to achieve rated specification.

DISPLAY

Screen: **2 lines of up to 6 digits, 5 mm (0.2") high**
 Display Rate: **2 readings/second (Adjustable to 1, 3, or 3.7 readings/second)**

LCD readable in sunlight.
 Changes to reading rate requires software: ConfigM30 is a free download from crystallengineering.net/downloads/30series.

POWER

1 x 9V: **90 hours, typical**

Uses one alkaline 9V battery. Use of USB interface reduces operating time.

WARNING: Do not use USB in hazardous locations.

DATA/COMMUNICATION

Digital Interface: **micro-USB**

Free Labview drivers available online.

WARNING: Do not use USB in hazardous locations.

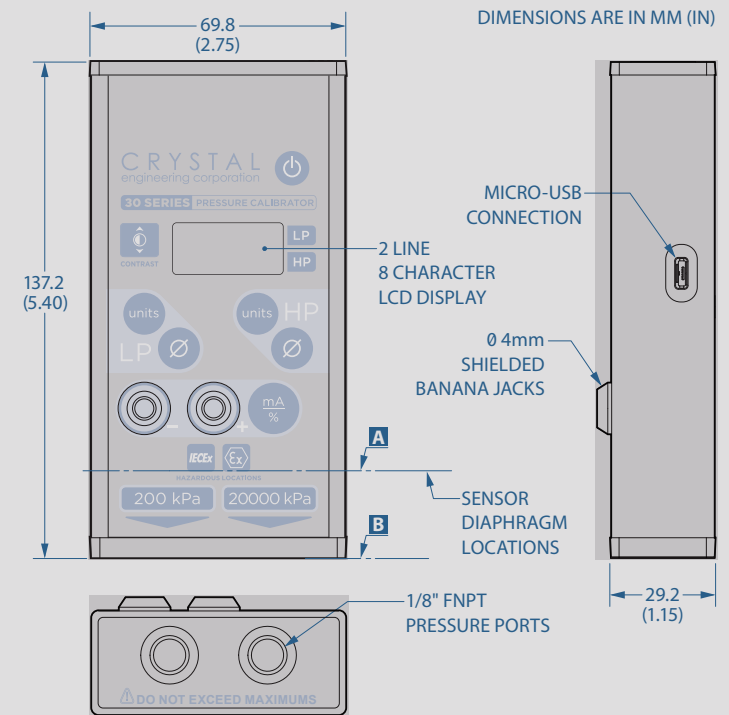

PRESSURE PORT VOLUMETRIC DATA:

LP distance to diaphragm (**A** to **B**): 22.4 (0.88")
 LP volume: 2 ml (0.13 cubic inches)
 HP distance to diaphragm (**A** to **B**): 17.8 (0.70")
 HP volume: 1 ml (0.06 cubic inches)

ENCLOSURE

Model 31 ≤ 2000 kPa:	342 g (12.0 oz)	<i>Weight includes batteries.</i>
* Model 31 ≤ 2000 kPa:	428 g (15.0 oz)	<i>*SPSS optional manifold.</i>
Model 31 ≥ 10 000 kPa:	360 g (13.0 oz)	<i>Nylon carry case included.</i>
Model 33:	400 g (14.0 oz)	
* Model 33:	485 g (17.0 oz)	
Housing:	Extruded aluminum	
Keypad and Labels:	UV resistant polyester	

SENSOR ≥ 10 000 kPa

Wetted Materials:	316 stainless steel	<i>All welded with a permanently filled diaphragm seal.</i>
Diaphragm Seal Fluid:	Dow Corning® 200	
Connection:	Bottom, 1/8" female NPT	

SENSOR ≤ 2000 kPa

Wetted Materials:	316 stainless steel, Viton® (o-ring)	<i>Viton o-ring is internal.</i>
	Anodized aluminum penetrated with PTFE (polytetrafluoroethylene)	<i>All welded with a permanently filled diaphragm seal.</i>
Diaphragm Seal Fluid:	Dow Corning® 200	
Connection:	Bottom, 1/8" female NPT	

STORAGE TEMPERATURE

Temperature Range:	-20 to 70° C (-4 to 158° F)	<i>Batteries should be removed if stored for more than one month.</i>
--------------------	------------------------------------	---

SPECIAL FEATURES

The following requires the use of **ConfigM30** software

- User Defined Unit: **Allows the user to define and display any pressure units not included, or to use the gauge to display force, level, or other pressure related parameters. Reduce or increase displayed resolution.**
- Remove: **Unwanted pressure units from Units button.**
- Password Protect: **Changes to configuration or userspan calibration factor(s).**
 - Save: **Configuration to a file.**
 - Copy: **Configuration to other calibrators.**

CERTIFICATIONS

**II 2G Ex ia IIC T4
FTZU 06 ATEX 0010 X**

This product conforms to:
EN 60079-0: 2006 | EN 60079-11: 2007



**II 2G Ex ia IIC T4 Gb
IECEx FTZU 10.0018 X**

This product conforms to:
IEC 60079-0: 2007 | IEC 60079-11: 2006



30 Series complies with the Electromagnetic Compatibility and the Pressure Equipment Directives. Refer to the EC Declaration of Conformity for specific details.



The instrument was tested against **AS/NZS 3584**, C-tick EMC/EMI requirements.



30 Series is approved for use as a portable test instrument for Marine use and complies with Det Norsjke Veritas' Rules for Classification of Ships, High Speed & Light Craft and Offshore Standards.

RANGE & RESOLUTION TABLES

P/N	Range (kPa)	Over-pressure	Display Resolution			
			kPa	MPa	bar	mbar
100	100	6.5 x	0.01		0.0001	0.1
200	200	3.0 x	0.01		0.0001	0.1
2000	2000	2.0 x	0.1		0.001	
10000	10000	2.0 x	1	0.001	0.01	
20000	20000	1.5 x	1	0.001	0.01	
30000	● 30000	1.5 x	1	0.001	0.01	

● Model 31 calibrators are not available in these ranges.

First Pressure Ranges	100 kPa	Second Pressure Ranges			
		2000 kPa	10000 kPa	20000 kPa	30000 kPa
100 kPa	■	■	■	■	■
200 kPa	■	■	■	■	■
2000 kPa		■	■		

Model 33 calibrators have dual pressure sensors. This chart shows all of the available sensor combinations. ■

ORDERING INFORMATION

Intrinsic Safety	Model	Sensor(s)	1st Pressure Range P/N	2nd Pressure Range P/N	Pressure Unit	Manifold
IS	3	_____	_____	_____	_____	_____
		Single Sensor: 1				Standard: (omit)
		Dual Sensor: 3				Stainless Steel: SPSS

SAMPLE PART NUMBERS

IS31-200KPA Calibrator with one sensor (200 kPa)

IS33-200/20000KPA Calibrator with two sensors (200 kPa and 20000 kPa)

IS33-100/10000KPA-SPSS ... Calibrator with two sensors (100 kPa and 10000 kPa) with two stainless steel manifolds

*KPA versions available in USA direct from factory only.

ACCESSORIES



Carry Case and Strap P/N 2490 (included)

A clear plastic cover protects the keypad while allowing operation of all the buttons.

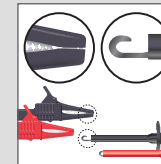

Test Leads P/N 1351

Our test lead kit features high quality banana to banana test leads with rugged, hard plastic insulated alligator clips.

COMPLIMENTARY PRODUCTS

Crystal Engineering offers a wide range of products that work with the XP2i:

- [Fittings that connect without tools, safely and without leaks](#)
- [Lightweight, super flexible high pressure hoses](#)
- [Fitting kits and adapters](#)
- [Pneumatic hand pumps](#)
- [Hydraulic hand pumps](#)
- [Portable pressure comparators](#)
- [Software, for the quickest way to calibrate pressure transmitters and gauges](#)

Dow Corning is a registered trademark of Dow Corning Corporation.

Viton is a registered trademark of DuPont Performance Elastomers.